

# Building 1000

## The Royals Business Park

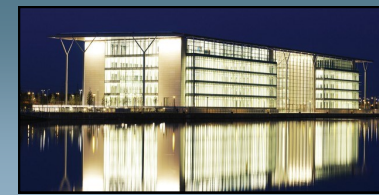
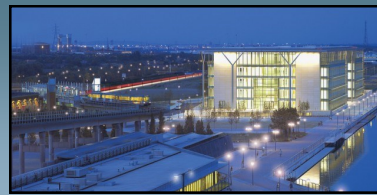

**Project:**  
Building 1000,  
The Royals

**Location:**  
Docklands, London

**M&E Contractor:**  
Derry Building  
Services

**Completion:**  
January 2004



Located just down-river from Canary Wharf, at the Royal Albert Dock, this stunning glass and steel building provides the highest specification of office accommodation.

The two five-storey buildings totalling 237,000ft<sup>2</sup> are linked by a spectacular Winter Garden and overlook the Olympic Rowing course, towards London's City Airport.

Each wing's central plant is controlled by a number of Trend IQ3 controllers, and a total of 650 Trend IQLs control airside Fan Coil Units. The system is networked by Ethernet to a PC with Trends' 963 Supervisor Software.